

S-5![®]

The Right Way![™]

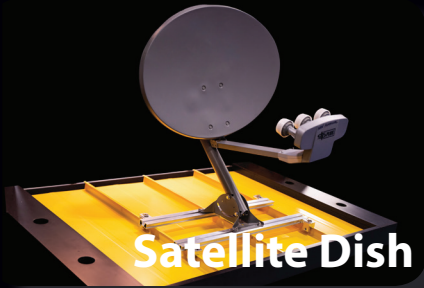

The right way to attach almost anything to metal roofs!



Satellite Dish



Junction Box

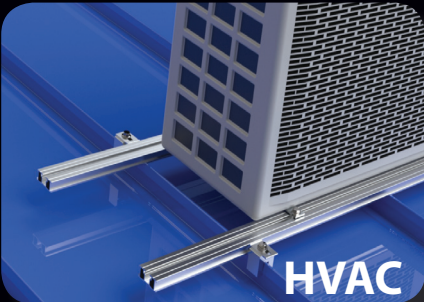

HVAC



Conduit

And More!

Don't damage your roof. GRIPPERFIX it!

Maintain roof warranties, avoid destructive corrosion and build a system to last the life of the roof, with the S-5![®] GRIPPERFIX System.

Stop mounting rooftop ancillary items using concrete blocks for ballast. GRIPPERFIX ensures a secure and dependable attachment solution - with no penetration of standing seam roof required. Our system is quick and simple to install and helps preserve the integrity of your metal roof.

Our universal GRIPPERFIX System makes mounting almost anything on standing seam and exposed fastener roof profiles a cinch!

What Do You Need to Attach to Your Metal Roof?

FEATURES AND BENEFITS

- No penetration of standing seam roof
- No field-applied sealants needed
- Ease of installation
- Eliminates corrosion and rust
- No damage to roof system
- Free flow of rainwater under struts
- Lower cost than all the wrong ways!

GRIPPERFIX[™]



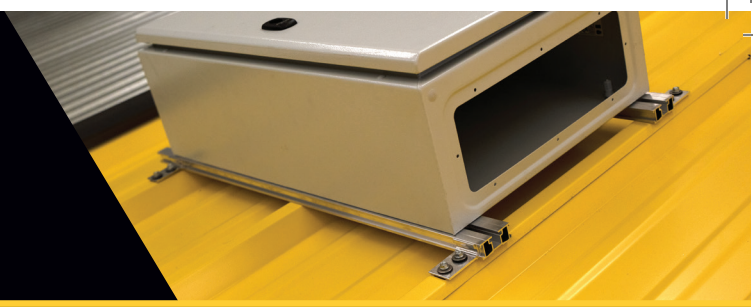

Exposed-Fastened Roof Components

The Wrong Way



The Right Way[™]



Improperly installing utilities on a metal roof can compromise both the equipment as well as the integrity of the roof itself. Long-term solutions demand long-term and durable attachment methods. *GRIPPERFIX* is a perfect fix for installing HVAC, satellite dishes, light fixtures, conduit, service walkways and other rooftop utilities.

Securely attach to an exposed-fastened roof while still allowing free flow of rainwater under the system. All you need is the *GRIPPERFIX* Strut, S-5! self-piercing fasteners, and EF Tabs. M8 bolts in three different lengths (1.25 x 16, 20, and 40 mm) are also available to use with the damper/leveling pad. Slide the tabs into the strut, and then fasten to the roof ribs. The result: an affordable, secure, rust-free, and long-lasting metal rooftop mount.

Gripper Strut

(Available in 26" and 52" lengths)

GF-26 (Satellite applications)

GF-52 (HVAC applications)

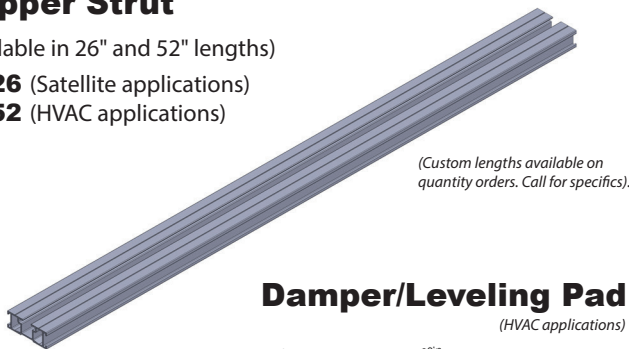

Damper/Leveling Pad

(HVAC applications)

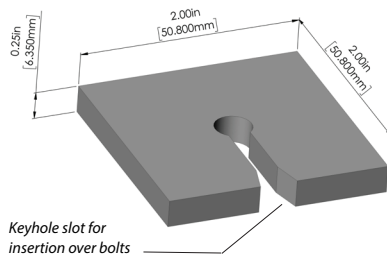

M8 1.25 x 16, 20, 40 mm Bolt

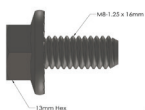

M8 Hex Flange Nuts

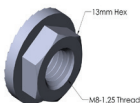

EF Tab

Special design interlocks securely with strut

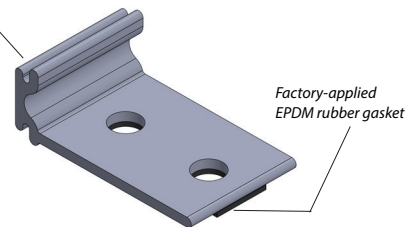

Piercing Fastener

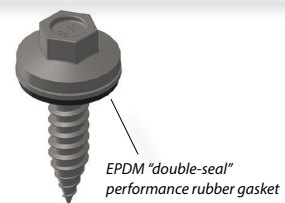

NOTE: In order to customize your solution, all components are sold separately.





Standing Seam Roof Components

The Wrong Way



The Right Way[™]

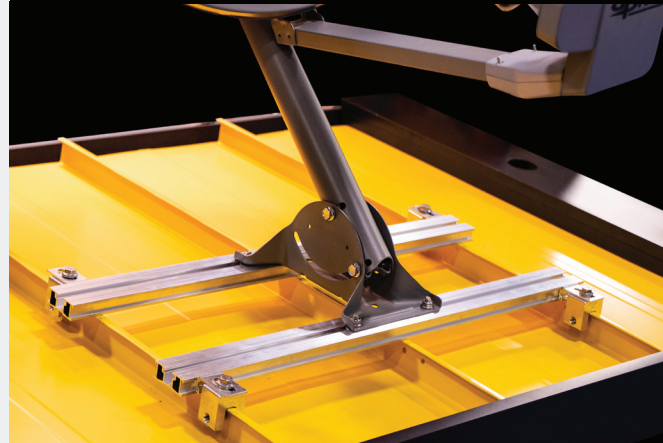

Standing seam profiles provide a durable and maintenance-free roof solution for decades. But the lifespan is significantly reduced when inferior rooftop mounting is performed. A perfect roof should first and foremost function as a roof and not as an equipment platform. But it is often convenient and necessary to attach rooftop ancillaries like a satellite dish or HVAC unit. Don't compromise warranties or safety – mount them *The Right Way!*[™]

GRIPPERFIX simplifies utility attachment with patented, non-penetrating S-5! clamp technology. Avoid damaging your roof. Choose a safe and cost-effective rooftop attachment system that requires only the strut, S-5 clamps, and CF Tabs. Just slide the tabs into the strut and attach to the top of the clamp with stainless bolts (provided). S-5! has made it easy and affordable - *The Right Way!*[™].

Gripper Strut

(Available in 26" and 52" lengths)

GF-26 (Satellite applications)

GF-52 (HVAC applications)

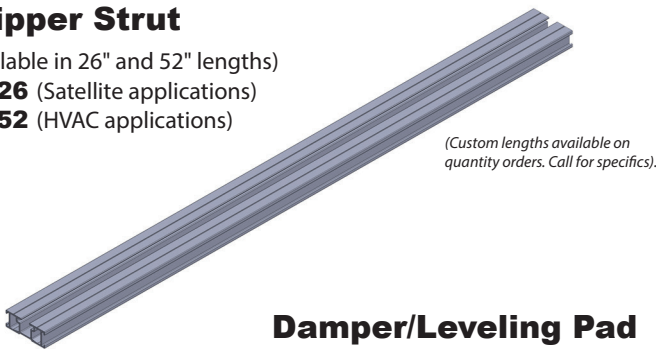

Damper/Leveling Pad

(HVAC applications)

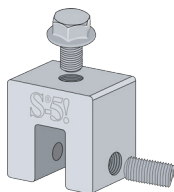
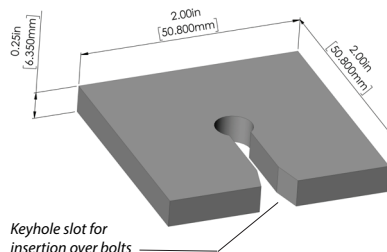

Select appropriate S-5 mini clamp for specific roof profile.

(Pictured above is the S-5-S Mini Clamp)

CF Tab

Slotted hole for adjustment

Special design interlocks securely with strut

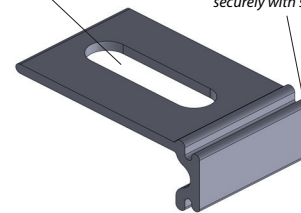

M8 1.25 x 16, 20, 40 mm Bolt

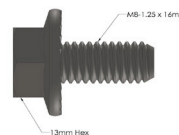

M8 Hex Flange Nuts

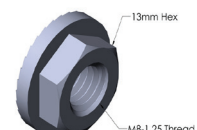

NOTE: In order to customize your solution, all components are sold separately.

GRIPPERFIX[™]



WHY CHOOSE THE GRIPPERFIX™ UTILITY MOUNTING SYSTEM?

Durable and Reliable:

Metal really is the smartest choice for roofs: Versatile, practical, and long-lasting are just a few of the advantages these roofs have over other materials.

Ease of Installation:

Simplify installation of metal roof utilities with the latest innovative attachment solution from S-5! - The universal GRIPPERFIX System. The GRIPPERFIX utility mounting system is the ultimate metal roof solution.

Solutions for Both Standing Seam and Exposed-Fastened Profiles:

Utilizing S-5! tabs, GRIPPERFIX employs our lifetime EPDM “double-seal” performance rubber gasket for exposed-fastened and trapezoidal roofs or can be mounted without any penetration on standing seam roofs with non-penetrating S-5! clamps.

ADDITIONAL FEATURES AND BENEFITS

- Universal utility system
- Use as many tabs as needed for your specific utility application
- All aluminum & stainless components
- Load distribution over multiple bearing points (panel ribs)

***The Right Way™* to install utilities on any metal roof.**

S-5!® Warning! Please use this product responsibly!

The independent lab test data found at www.S-5.com can be used for load-critical designs and applications. Products are protected by multiple U.S. and foreign patents. For published data regarding holding strength, fastener torque, patents, and trademarks, visit the S-5! website Copyright 2019, Metal Roof Innovations, Ltd. S-5! products are patent protected.

Copyright 2019, Metal Roof Innovations, Ltd. Version 061719

U.S. and Foreign Patents Pending

GRIPPERFIX™