



FFD35-12

(Group Size: U1)

Deep Cycle Sealed
Maintenance-Free
AGM Battery



| CRANKING PERFORMANCE | |
|----------------------|---------|
| CA 32°F | CCA 0°F |
| 275 | 225 |

| RESERVE CAPACITY |
|------------------|
| @25 AMPS |
| 50 Minutes |

| CONSTANT CURRENT DISCHARGE (Amps) | | | | | | | | | | | | |
|-----------------------------------|------|------|-----|----|----|-----|-----|------|-----|------|------|-----|
| CUT OFF VOLTAGE V/cell | 15M | 30M | 45M | 1H | 2H | 3H | 5H | 8H | 10H | 12H | 20H | 24H |
| 1.75V | 43.7 | 26.8 | 26 | 22 | 11 | 7.5 | 4.7 | 3.25 | 2.7 | 2.35 | 1.75 | 1.5 |

| SPECIFICATIONS | | |
|-------------------------------|------------------------------------|------------------|
| Nominal Voltage | | 12 Volt |
| Rated Capacity (20 hour rate) | | 35 AH |
| Dimensions | Total Height (including terminals) | 167 mm (6.57") |
| | Height | 155 mm (6.10") |
| | Length | 196 mm (7.72") |
| | Width | 131 mm (5.16") |
| Weight | | 10 kg (22.1 lbs) |

| CHARACTERISTICS | | |
|--|------------------------------------|---|
| Capacity 77°F (25°C) | 20 Hour Rate (1.75A to 10.5 Volts) | 35AH |
| | 10 Hour Rate (3.2A to 10.5 Volts) | 32AH |
| | 5 Hour Rate (5.8A to 10.2 Volts) | 29AH |
| Internal Resistance | Full charged Battery 77°F (25°C) | 9m Ω |
| Capacity Affected by Temperature (20 Hour Rate) | 104°F (40°C) | 102% |
| | 77°F (25°C) | 100% |
| | 32°F (0°C) | 85% |
| | 5°F (-15°C) | 65% |
| Self-Discharge 77°F(25°C) | Capacity after 3 month storage | 91% |
| | Capacity after 6 month storage | 82% |
| | Capacity after 12 month storage | 64% |
| Max. Discharge Current | 450A (5s) | |
| Terminal | Standard | M6 |
| Charging (Constant Voltage) | Cycle | Initial Charging Current $\leq 0.2 \times C20$ 14.5 V ~ 14.9 V/77°F (25°C) |
| | Float | 13.6 V ~ 13.8 V/77°F (25°C) |

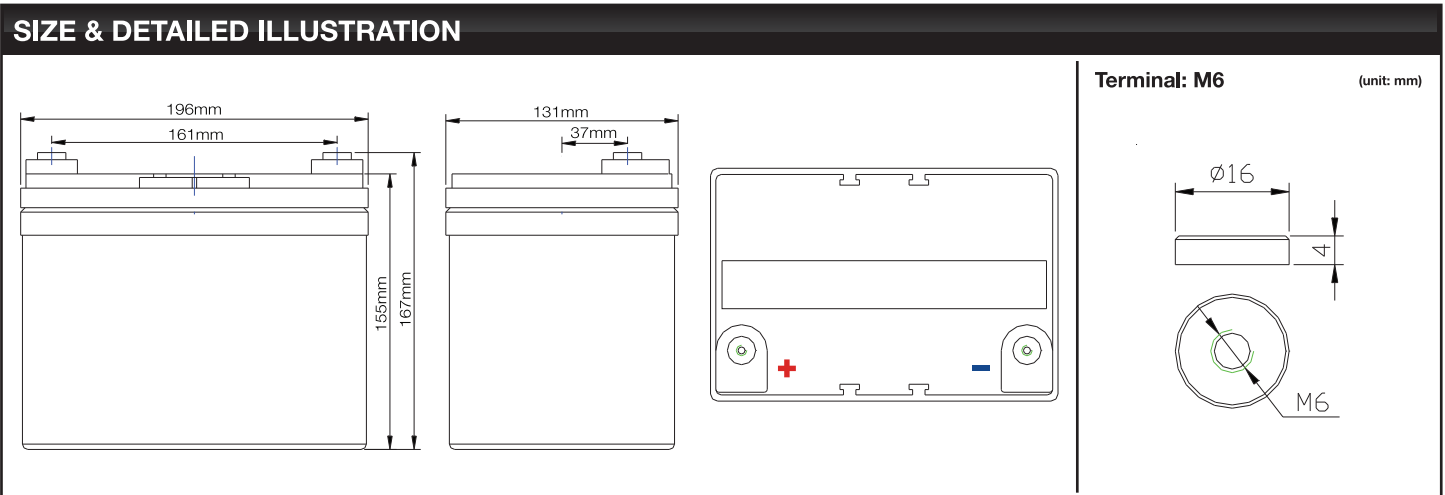
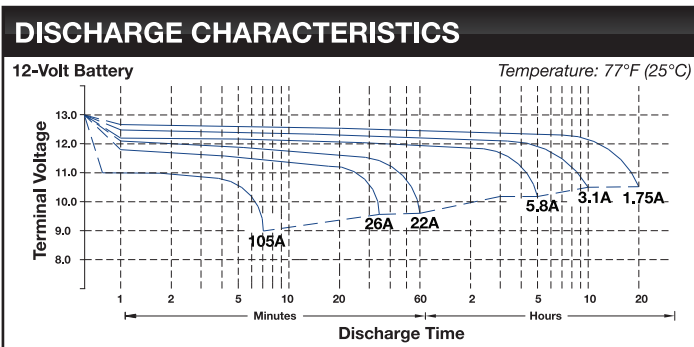

This information is generally descriptive only and is not intended to make or imply any representation, guarantee or warranty with respect to any cells and batteries. Cell and battery designs/specifications are subject to modifications without notice. Contact Fullriver for the latest information.