



VRLA Rechargeable Battery

BP220-6 (BP220-6FR)

FEATURES

- Maintenance free(no water topping-up required)
- No free acid(Non-spillable battery)
- Can be used in any orientation(excluding used inverted)
- Flame-arrestor is installed to ensure safety
- Absorbent Glass Mat technology for efficient gas recombination

APPLICATION

- UPS
- Telecom

SPECIFICATIONS

Nominal Voltage	6V	
Nominal Capacity	20 Hour Rate (11.0A, 5.25V)	220 Ah
	10 Hour Rate (20.9A, 5.25V)	209 Ah
	5 Hour Rate (37.4A, 5.25V)	187 Ah
	1 Hour Rate (132A, 4.65V)	132 Ah
Approx. Weight	32.7Kg(72.1lbs.)	
Terminals	I3 (M8 Female thread)	
Max. Discharge Current	800 A (5 sec.)	
Max. Charge Current	66 A	
Operating Temperature Range	Charge	0°C~40°C(32°F~104°F)
	Discharge	-20°C~50°C(-4°F~122°F)
	Storage	-20°C~40°C(-4°F~104°F)
Self Discharge	< 3% per month (25°C)	
Internal Resistance	≤1.7mΩ (Fully Charged)	



CONTAINER MATERIAL

- BP220-6:
ABS: UL 94-HB (Dark gray color)
- BP220-6FR:
ABS: UL 94-V0 (Light gray color)

 ISO 9001	 ISO14001
 MH19884 UL	 C4M20310-2474-E-16 CE
<ul style="list-style-type: none"> ● IEC60896 ● GB/T 19638 	<ul style="list-style-type: none"> ● JIS C 8704

OUTER DIMENSIONS mm(inch)	Length (L)	Width (W)	Container Height (H)	Total Height (TH)
	244±2.0(9.61±0.08)	190±2.0(7.48±0.08)	259.5±2.0(10.22±0.08)	275±2.0(10.83±0.08)

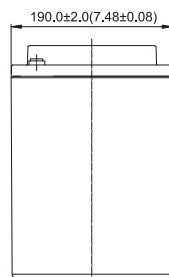
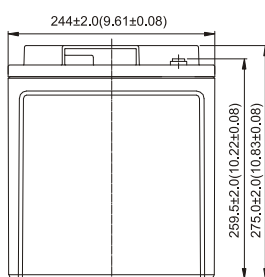
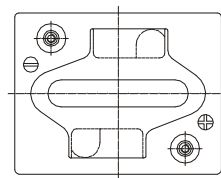

TERMINAL TYPE

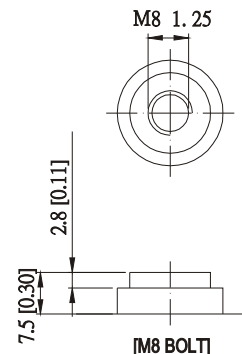

Terminal Hardware Initial Torque:
I3(10.0Nm±5%)

BP220-6 (BP220-6FR) Battery discharge characteristics (25°C/77°F)

Battery Charging Characteristics

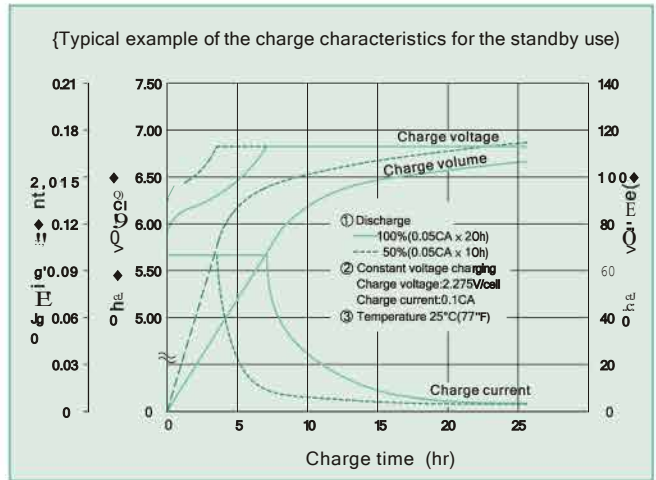
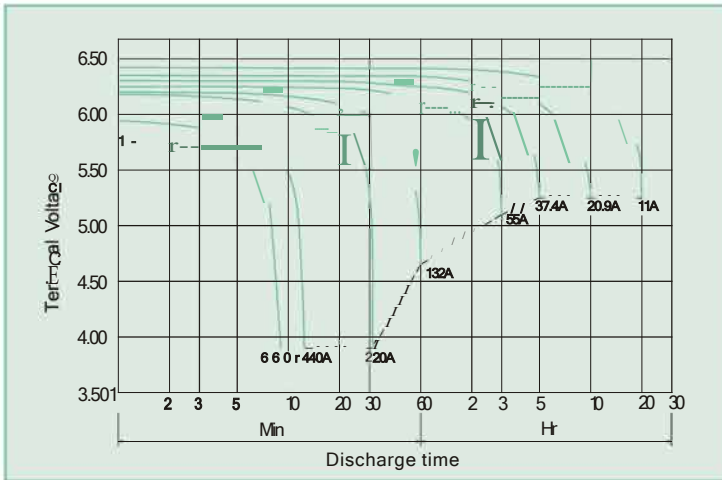

Charging Procedure

Application	Charging method	Charging Voltage at 25°C (V/cell)	Temperature compensation coefficient of charging voltage (mV/°C/cell)	Max. charging current (CA)	Charging time 0.1CA, 25°C (h)		Temp (°C)
					100% discharge	50% discharge	
For standby power Source	Constant voltage & Constant current charging (with current restriction)	2.25-2.30	-3	0.3	24	20	0-40 (3r104 °F)
For cycle service		2.40-2.50	-4	0.3	16	10	

Effect Of Temperature On Long Term Float Life

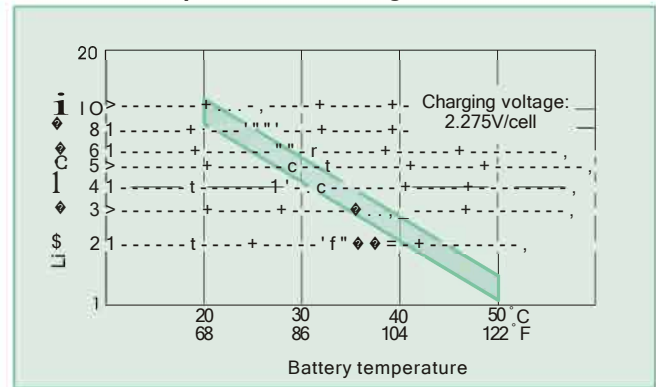

Constant power discharge characteristics at 25 °C/77 °F Unit: W

g e (V/cell)	15 Min	30 Min	1 Hr	3 Hr	5 Hr	10 Hr	20 Hr
1.80V	2117	1423	800.7	320.6	221.1	123.5	65.18
1.75V	2215	1478	824.5	327.0	224.4	125.4	66.00
1.70V	2283	1511	839.4	330.0	225.6	126.0	66.33
1.65V	2335	1532	849.5	332.3	226.5	126.4	66.50
1.60V	2382	1548	858.0	334.3	227.1	126.4	66.50

Constant current discharge characteristics at 25 °C/77 °F Unit: A

g e (V/cell)	15 Min	30 Min	1 Hr	3 Hr	5 Hr	10 Hr	20 Hr
1.80V	368.2	241.3	134.6	53.43	36.85	20.59	10.86
1.75V	385.2	250.5	138.6	54.50	37.40	20.90	11.00
1.70V	397.0	256.2	141.1	55.00	37.61	21.01	11.06
1.65V	406.2	259.7	142.8	55.39	37.74	21.06	11.08
1.60V	414.3	262.4	144.2	55.71	37.84	21.06	11.08

All data shall be changed without prior notice, BB reserves the right to explain and update the information contained hereinto.

Trial NO REV. Aug . 2009

<p>USA: B&B BATTERY(USA) INC. 6415 RANDOLPH ST.COMMERCE,CA,90040 U.S.A. TEL: 1-323-278-1900.1-800-278-8599 FAX: 1-323-278-1268 E-Mail:sales@bb-battery.com</p> <p>CIDNA FACTORY: B.B. BATTERY CO., LTD. CHENG DONG TRIALAREA,HUANG GANG, RAOPING, GUANG DONG,CHINA,515700 TEL:86-768-7601001-2 FAX:86-768-7601469 E-Mail:maggy@bb-battery.com</p>	<p>EUROPE: B&B BATTERY(EUROPE) B.V. LAAN VAN KRONENBRUG 8, 1183AS AMSTELVEEN, THE NETHERLANDS TEL: +852-91282711 MOBILE: +852-91282711 E-Mail: dliu@bb-battery.com</p> <p>HONGKONG: NATIONAL TRADING LTD. TEL:852-2301-3800 FAX:852-2739-1182 E-Mail:bbhk@hkstar.com</p>	<p>JAPAN: B&B BATTERY(JAPAN) CO., LTD. 1375-11 NARAHARA-MACHI,HACHIOJI, TOKYO 193-0803,JAPAN. TEL:81-426-25-6375 FAX:81-426-25-6375 E-Mail:miyata@bb-battery.com</p> <p>TAIWAN: B.B. BATTERY(TAIWAN) CO., LTD. TEL:886-6-502-5150 FAX:886-6-589-8087 E-Mail:maggy@bb-battery.com</p>
---	--	--